

Product data sheet

Characteristics

XVEL6M6

Ø 70 mm tower light - flashing - blue - up to IP42 - 230..240 V



Main

Range of product	Harmony XVE Optimum
Product or component type	Complete illuminated beacon
Beacon or indicator bank unit type	1 base unit 1 illuminated unit 1 screw fixing cover 1 short fixing base
Signalling type	Flashing
Component name	XVE
Light source	Integral flash discharge tube, blue
Bulb type	Flash discharge tube
[Us] rated supply voltage	230...240 V AC

Complementary

Mounting diameter	70 mm
Flash energy	1 J
Connections - terminals	Screw clamp terminals, <= 1 x 1.5 mm ² with cable end
Marking	CE
Short-circuit protection	0.16 A
[Ui] rated insulation voltage	250 V conforming to IEC 60947-1
Nominal voltage limit	0.85...1.1 Un conforming to IEC 60947-5-1
Current consumption	< 25 mA
[Uimp] rated impulse withstand voltage	4 kV IEC 60947-1
Flashing frequency	1 Hz
CAD overall width	70 mm
CAD overall height	129 mm
CAD overall depth	70 mm
Terminals description ISO n°1	(COM-1)PW (GND)GROUND
Net weight	0.27 kg

Environment

Standards	EN/IEC 60947-5-1 EN/IEC 60947-1
Product certifications	UL CCC CSA
Ambient air temperature for storage	-40...70 °C
Ambient air temperature for operation	-25...55 °C
Electrical shock protection class	Class I aluminium tube mounting conforming to IEC 61140 Class I plastic tube mounting conforming to IEC 61140
Protective treatment	TC
IP degree of protection	IP40 any position except vertical position conforming to IEC 60529 IP42 vertical position conforming to IEC 60529

The information provided in this documentation contains general descriptions and/or technical characteristics of the performance of the products contained herein. This documentation is not intended as a substitute for and is not to be used for determining suitability or reliability of these products for specific user applications. It is the duty of any such user or integrator to perform the appropriate and complete risk analysis, evaluation and testing of the products with respect to the relevant specific application or use thereof. Neither Schneider Electric Industries SAS nor any of its affiliates or subsidiaries shall be responsible or liable for misuse of the information contained herein.

Offer Sustainability

REACH Regulation	REACH Declaration
EU RoHS Directive	Pro-active compliance (Product out of EU RoHS legal scope) EU RoHS Declaration
Mercury free	Yes
RoHS exemption information	Yes
China RoHS Regulation	China RoHS Declaration
WEEE	The product must be disposed on European Union markets following specific waste collection and never end up in rubbish bins

Contractual warranty

Warranty	18 months
----------	-----------

Illuminated Beacon

Dimensions

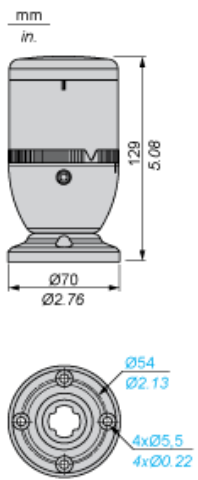

Illuminated Beacon

Panel Cut-out for Mounting Directly on Fixing Base

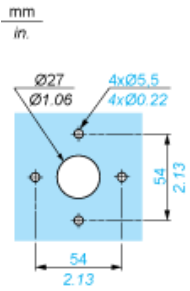

Illuminated Beacon

Wiring Diagram

