



## Main

Range of product	Telemecanique Cabling components
Accessory / separate part category	Cabling accessories
Accessory / separate part type	Connector
Electrical connection	Elbowed female connector DIN 43650 A, 4 pins
Status LED	Without
Cable connection	Screw terminal / wire size <1.5 mm <sup>2</sup> / clamping capacity 7...10 mm

## Complementary

Cable gland type	Pg 11
Cable connector fixing	Locking screw
[Ue] rated operational voltage	250 V AC
[In] rated current	16 A
Enclosure material	Plastic
Minimum insulating resistance	0.1 GΩ
Contact resistance	4000 μOhm
Net weight	0.035 kg



## Environment

IP degree of protection	IP65
Ambient air temperature for operation	-40...125 °C

## Packing Units

Unit Type of Package 1	PCE
Number of Units in Package 1	1
Package 1 Height	3.000 cm
Package 1 Width	10.000 cm
Package 1 Length	10.000 cm
Package 1 Weight	33.000 g
Unit Type of Package 2	S02
Number of Units in Package 2	50
Package 2 Height	15 cm
Package 2 Width	30 cm
Package 2 Length	40 cm
Package 2 Weight	1.962 kg

## Offer Sustainability

REACH Regulation	 <a href="#">REACH Declaration</a>
EU RoHS Directive	Pro-active compliance (Product out of EU RoHS legal scope)
Mercury free	Yes
RoHS exemption information	 Yes
California proposition 65	WARNING: This product can expose you to chemicals including: Diisononyl phthalate (DINP), which is known to the State of California to cause cancer, and Di-isodecyl phthalate (DIDP), which is known to the State of California to cause birth defects or other reproductive harm. For more information go to <a href="http://www.P65Warnings.ca.gov">www.P65Warnings.ca.gov</a>

## Contractual warranty

Warranty	18 months
----------	-----------

## Dimensions

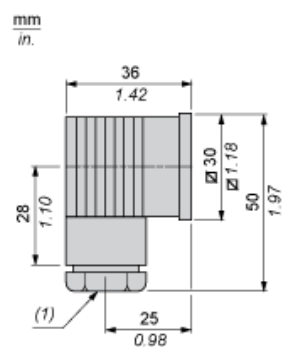

---

## Connections and Schemes

---

